



MPJP0201001 20 Nest layer cage with 2 levels

Characteristics

- ◆ Complete Unit of 20 nest Layer cage with 2 levels.
- ◆ 4 cages of 5 nests for layers, stacked on top of each other, includes the galvanized legs, trough PVC feeder and automatic drinking system for layers. (Also includes: in-line shut-off, filter element, mechanism pipe and connexions)

Capacity

- ◆ 48 layers per module (1 to 3 layers per nest and maximum 15 layers per cage)

Advantages

- ◆ Manufactured modularly to help the expansion to increase the number of layers per house.
- ◆ 100% galvanized cage system.
- ◆ Galvanized wire divisions to provide better ventilation and visibility.
- ◆ Double galvanized Steel Mesh floor with narrow divisions that provides more comfort and safety
- ◆ Easy to clean feeding system.
- ◆ Manufactured with high quality PVC conditioned with UV, UVR and antioxidant protection for maximum resistance and durability under any environment.
- ◆ Automatic drinking system, hygienic and easy to clean and disinfect.

Material

Galvanized Steel wire, caliber 12 and 14.

- ◆ Galvanized after welded to ensure all the cages are
- ◆ 100 % galvanized, preventing corrosion or rusting.

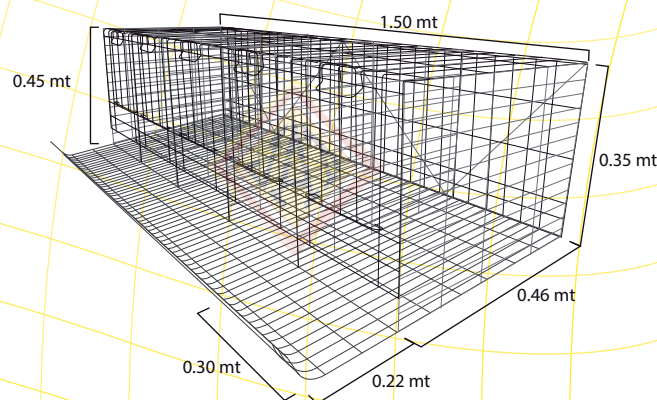
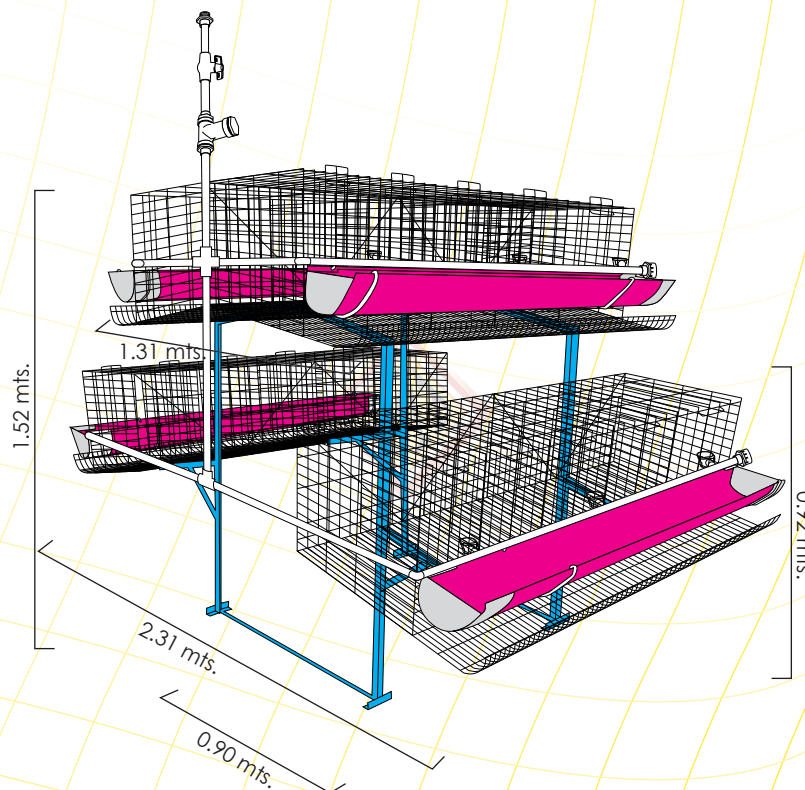

Components



CCGP0203001
PVC Trough /
canal feeder, for layer 5mt.



TCCD0203001
Plug to canal feeder, right side.



TCCI0203001
Plug to canal feeder, left side.



GCCJ0203001
Galvanized hook 1/4 for canal
feeder in round.



UCCD0203001
Canal feeder union



GJPG0203001
Canal feeder staple



BAGJ0104001
Automatic cup waterer (layers)



MTLX0103003
Washer for cup drinker



MTLX0103008
2.9 cm Short trigger



MTLX0103010
3.1 cm Large trigger



FPAV0104001
1" Filter



CNXX0204005)
1/2" Stopcock



CNXX0104002
Special saddle



CNXX0104004
1/2" PVC pipe



CNXX0104008
Special saddle joiner 20cm



CNXX0103003
1" Filter converter



CNXX0103001
1" Female Cap



CNXX0204003
1/2" Elbow Connexion



CNXX0204004
1/2" Tee connexion



CNXX0204001
1/2" Four way connexion

Packing

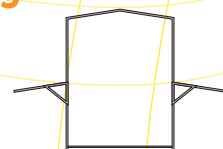
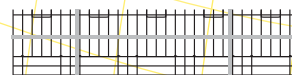

Capacity:	1 Tied	1 Tied
- Weight:	35.0 kg.	11.5 kg.
- Long:	1.5 mts.	1.79 mts.
- Width:	0.69 mts.	0.5 mts.
- Height:	0.52 mts.	1.17 mts.

Complementary Products



BAIJ0104001
Initiation automatic cup waterer



BAGJ0104001
Automatic cup waterer (layers)